

DATE	BY	REVISION RECORD	AUTH.	DR.	CK.

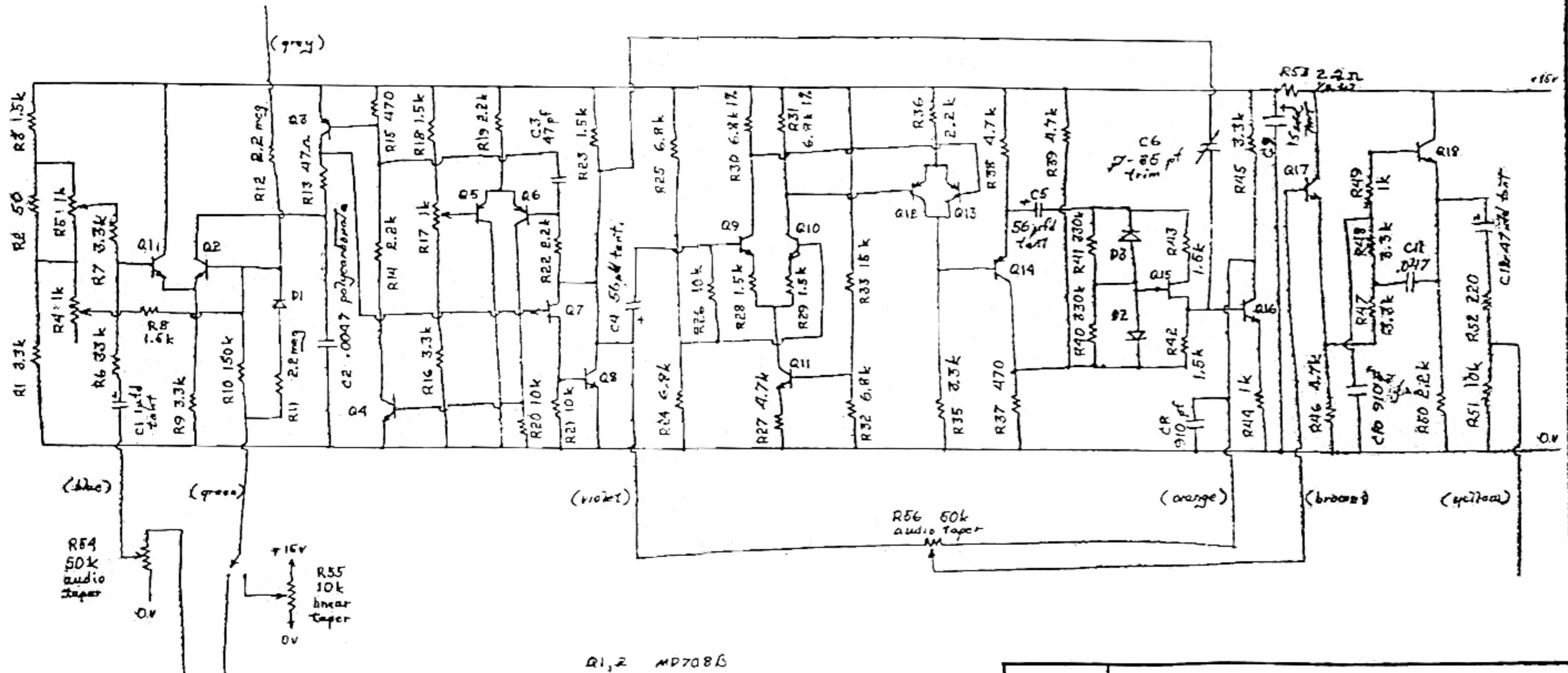

- C's 12
- D's 3
- R's 18
- R's 56

- Q1,2 MP708B
- Q3,5,6,12-14 2N4916
- Q9,8-11,16-18 2N3865
- Q7 U147
- Q15 E101 [select for $I_{DSS} \approx 5mA$]
- [drop C7, R34]

TOLERANCES (EXCEPT AS NOTED)	BUSHLA ASSOCIATES		
DECIMAL	MODULAR ELECTRONIC	SCALE	DRAWN BY DB
±	MUSIC SYSTEM	—	APPROVED BY
FRACTIONAL	TITLE		
±	SCH. SINE SAW OSS. MODEL 158A		
ANGULAR	DATE	DRAWING NUMBER	
±	4-1-68	B1580A	

DATE	SYM	REVISION RECORD	AUTH.	DR.	CK.

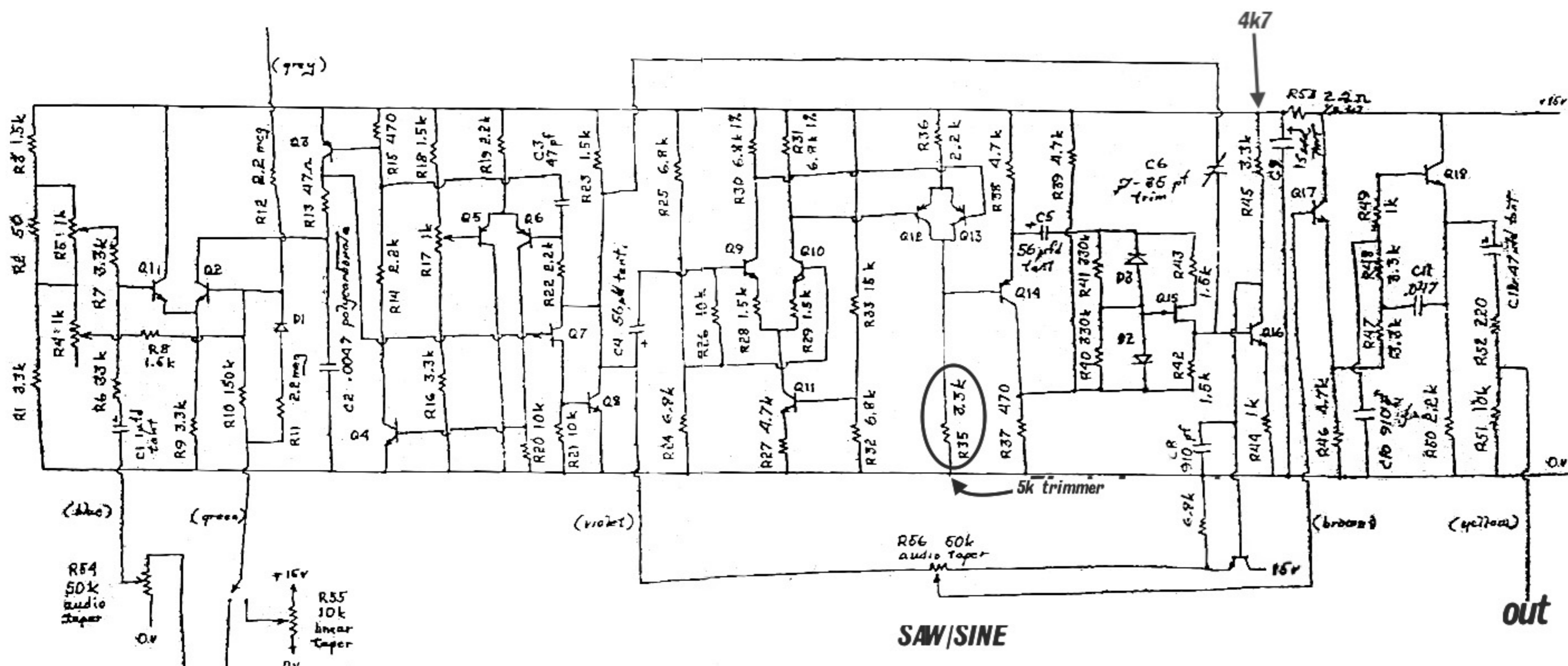

C's 12
 D's 3
 Q's 18
 R's 56

FM **FREQ**

Q1,2 MP708B
 Q3,5,6,12-14 2N4916
 Q9,8-11,16-18 2N3866
 Q7 U147
 Q15 E101 [select for $I_{DSS} \approx 5mA$]
 [drop C7, R34]

SAW/SINE

TOLERANCES (EXCEPT AS NOTED)	BUSHA ASSOCIATES		
DECIMAL	MODULAR ELECTRONIC	SCALE	DRAWN BY: DB
±	MUSIC SYSTEM	—	APPROVED BY:
FRACTIONAL	TITLE		
±	SCH. SINE SAW OSC. MODEL 158A		
ANGULAR	DATE	DRAWING NUMBER	
±	4-1-68	B1580A	

